

Warning

- Please read this handling manual carefully before you operate this product.
- Please keep this handling manual at convenient place, and make sure that you can read it anytime necessary.
- Please follow the instruction in this manual and usage of this production.
- Please learn the indication of safety in this manual and follow the indication.

Please stay closely to these indications above.
If you do not follow these indications, it may cause injury and accident.

For safe and correct handling

This handling manual contains various pictures in order to guide users to use this product correctly and to prevent any damage and danger. Please check the detail bellow.

Danger If you ignore this indication and operate this product incorrectly, it is highly possible to cause death or serious injury to people.

Warning If you ignore this indication and operate this product incorrectly, it may cause death or serious injury to people.

Attention If you ignore this indication and operate this product incorrectly, it may cause damage to people and product.

1.Name of Each Part

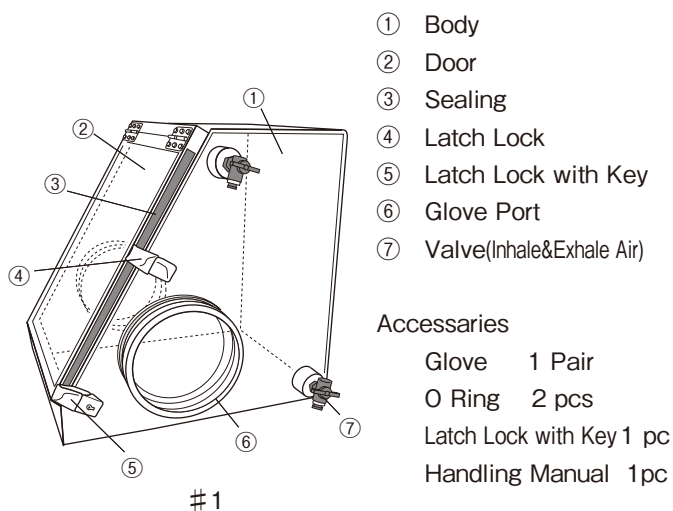

2.How to Setting

Please put this product on stable place.

Warning

Set this product on stable place

It may turns over on unstable place.

Then, connect tube which introducing gas to valve at one side, and connect tube which exhale gas from valve at the other side. Please check the picture #2 for reference of how to connect. Also, please use outside diameter 6mm as a connect tube.

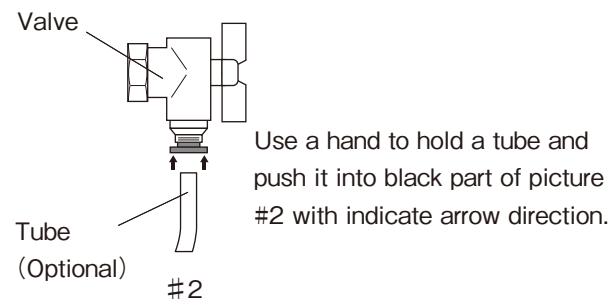

After that, please attach gloves to glove port. As picture #3 after attach gloves to glove port, fit O ring to the ditch of glove port. At that time, place gloves without wrinkles. Any wrinkles may cause leak.

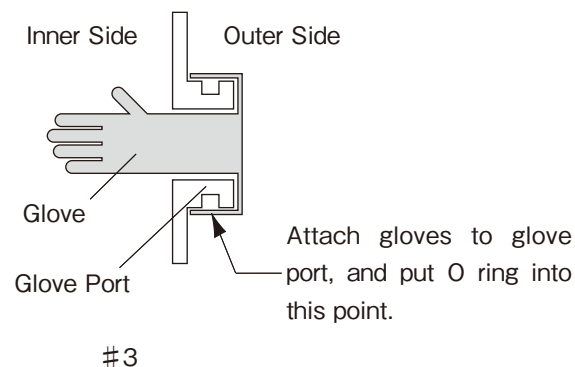

3.How to Use

Danger

Prohibit to use explosive and inflammable material, or poisonous gas

Must not use any explosive and inflammable material, or poisonous gas.

Warning

Please use this product under normal temperature

Please use this product under normal temperature.
It may cause damage or transformation by using it except normal temperature.

Warning

Prohibit to use any chemical which affect acrylic acid resin

This product's body and door are made from acrylic acid resin.
If you use any chemical which affect acrylic acid resin, it may cause damage or transformation.

Way of Gas Replacement

3-1

Place any object which using inside of glove box compact, then close latch lock and latch lock with key. Please lock it if it is necessary.

3-2

Open both valves, then introduce gas to inside. At this time, you must open exhale valve, to avoid inside is under pressure condition. Also, this product is not suitable for vacuum, so don't make it to decompression condition. Please check picture #4 for open and close valve condition.

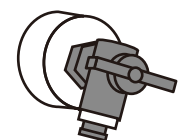

Valve under closed condition



Valve under open condition

#4

Warning

Please use this product under normal pressure condition

Do not make inside of this product under pressurized or depressurized condition.
It may cause damage or transformation.

Also, please take proper care to exhaled gas.

Warning

Take proper care to exhaled gas

If you handle harmful materials with improper care of exhale gas, it may influence human body.

3-3

After you complete to make your target surroundings inside of glove box, stop the gas supply and close both valves. In order to check the valve is open or close, please refer to picture #4.

3-4

Please insert your hands into gloves and start any operation. If you feel any difficulty to fit your hands to gloves, open exhale gas valve a little to decrease inside pressure, then close valve.

4.Maintenance

Attention

Please use soft fabric and neutral detergent for clean up

It may cause damage or transformation if you use hard fabric or solvent kind chemicals.

5.Specifications

Outer Size (include a projection part)	409W×416D×405H mm(as reference)
Inner Size	290W×190D/390D×390H mm
Body Opening Part Size	250×325 mm
Glove Port Inner Diameter	φ140 mm
Valve Connector Tube Mouth Outer Diameter	φ6 mm
Weight	about 5.5 kg

6.About Handling Manual

- We may change the contents of this handling manual without making any announcement in the future because of the improvement of its function or performance.
- It is prohibited to reprint and to reproduce this handling manual without permission.
- If you lost this handling manual, please contact us.
- We double check contents of this handling manual, but if you find any misprinting or error information please contact us.

SANPLATEC CORP.

URL <http://www.sanplatec.co.jp>

■Head Office
No.1-3, 2-chome Doshin, Kita-Ku, Osaka City, 530-0035 JAPAN
TEL : 816-6353-5141 FAX : 816-6353-5975

■Tokyo Branch
No.11, Kanda Kita-Norimono-Chou, Chiyoda-ku, TOKYO, 101-0036 JAPAN
TEL : 813-3252-4461 FAX : 813-3252-4462

■Nagoya Branch
No.22-12, 1-chome Shimizu Kita-Ku, Nagoya City, 462-0844 JAPAN
TEL : 8152-962-0291 FAX : 8152-962-0293